



TWO PIECE SWAGED FITTINGS UNIVERSAL SERIES FOR WIRE BRAIDED AND 4 SPIRAL HYDRAULIC HOSES
RACCORDI A PRESSARE - SERIE UNIVERSALE PER TUBI TRECCIATI E 4 SPIRALI
PRESSARMATUREN UNIVERSALSERIE FÜR GEFLECHT - UND SPIRALSCHLÄUCHE
RACORES A PRENSAR SERIE UNIVERSAL PARA MANGUERA DE UNA O DOS MALLAS Y 4 ESPIRALES

BSP

FP11B

10213-VL

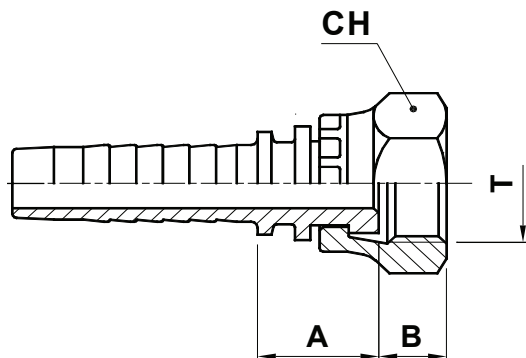

BSP FLAT FACE FEMALE SWIVEL

FEMMINA BSP FACCIA PIANA DIRITTA

BSP FLACHDICHTEND BSP GEWINDE
HEMBRA GIRATORIA RECTA BSP CON
ASIEN TO PLANO

CODE CODICE BEST.-NR CODIGO	Ø HOSE Ø TUBO Ø SCHLAUCH Ø MANGUERA			T	A		B		CH		
	DN	INCH	SIZE		[mm]	[in]	[mm]	[in]	[mm]	[in]	↗[in]
FP11B-06-06	10	3/8"	06	3/8" - 19	15,5	0,61	9	0,35	22	0,866	7/8"
FP11B-06-08	10	3/8"	06	1/2" - 14	16	0,63	10,5	0,41	27	1,063	1.1/16"
FP11B-08-08	12	1/2"	08	1/2" - 14	16,5	0,65	10,5	0,41	27	1,063	1.1/16"
FP11B-08-12	12	1/2"	08	3/4" - 14	21,5	0,85	11,5	0,45	32	1,260	1.1/4"
FP11B-12-12	19	3/4"	12	3/4" - 14	19	0,75	11,5	0,45	32	1,260	1.1/4"