



TWO PIECE SWAGED FITTINGS UNIVERSAL SERIES FOR WIRE BRAIDED AND 4 SPIRAL HYDRAULIC HOSES
RACCORDI A PRESSARE - SERIE UNIVERSALE PER TUBI TRECCIATI E 4 SPIRALI
PRESSARMATUREN UNIVERSALSERIE FÜR GEFLECHT - UND SPIRALSCHLÄUCHE
RACORES A PRENSAR SERIE UNIVERSAL PARA MANGUERA DE UNA O DOS MALLAS Y 4 ESPIRALES

JIC

MJ10B

10220

JIC 37° MALE

MASCHIO JIC CONO 37°

**AGJ JIC-ANSCHLUSSSTUTZEN 37°
KONUS MIT UNF GEWINDE**

MACHO FIJO JIC 37°

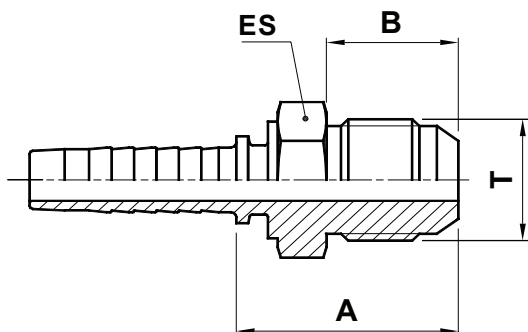

CODE CODICE BEST.-NR CODIGO	Ø HOSE Ø TUBO Ø SCHLAUCH Ø MANGUERA			T	A		B		ES		
	DN	INCH	SIZE		[mm]	[in]	[mm]	[in]	[mm]	[in]	↗[in]
MJ10B-03-04	5	3/16"	03	7/16" - 20	25,8	1,02	14	0,55	14	0,551	9/16"
MJ10B-04-04	6	1/4"	04	7/16" - 20	26,5	1,04	14	0,55	14	0,551	9/16"
MJ10B-04-05	6	1/4"	04	1/2" - 20	26,5	1,04	14	0,55	14	0,551	9/16"
MJ10B-04-06	6	1/4"	04	9/16" - 18	27,5	1,08	14	0,55	17	0,669	11/16"
MJ10B-05-05	8	5/16"	05	1/2" - 20	26,5	1,04	14	0,55	14	0,551	9/16"
MJ10B-05-06	8	5/16"	05	9/16" - 18	27,5	1,08	14	0,55	17	0,669	11/16"
MJ10B-06-06	10	3/8"	06	9/16" - 18	27,5	1,08	14,1	0,56	17	0,669	11/16"
MJ10B-06-08	10	3/8"	06	3/4" - 16	30,2	1,19	16,7	0,66	19	0,748	3/4"
MJ10B-06-10	10	3/8"	06	7/8" - 14	34,8	1,37	19,3	0,76	24	0,945	15/16"
MJ10B-08-06	12	1/2"	08	9/16" - 18	28,1	1,11	14,1	0,56	19	0,748	3/4"
MJ10B-08-08	12	1/2"	08	3/16" - 12	30,7	1,21	16,7	0,66	19	0,748	3/4"
MJ10B-08-10	12	1/2"	08	7/8" - 14	35	1,38	19,3	0,76	24	0,945	15/16"
MJ10B-08-12	12	1/2"	08	1.1/16" - 12	39	1,54	21,9	0,86	27	1,063	1.1/16"
MJ10B-10-08	16	5/8"	10	3/4" - 16	33,7	1,33	16,7	0,66	24	0,945	15/16"
MJ10B-10-10	16	5/8"	10	7/8" - 14	35,3	1,39	19,3	0,76	24	0,945	15/16"
MJ10B-10-12	16	5/8"	10	1.1/16" - 12	38,9	1,53	21,9	0,86	27	1,063	1.1/16"
MJ10B-12-10	19	3/4"	12	7/8" - 14	36,8	1,45	19,3	0,76	27	1,063	1.1/16"
MJ10B-12-12	19	3/4"	12	1.1/16" - 12	39,4	1,55	21,9	0,86	27	1,063	1.1/16"
MJ10B-12-14	19	3/4"	12	1.3/16" - 12	40,1	1,58	22,6	0,89	32	1,260	1.1/4"
MJ10B-12-16	19	3/4"	12	1.5/16" - 12	45,6	1,80	23,1	0,91	36	1,417	1.7/16"

