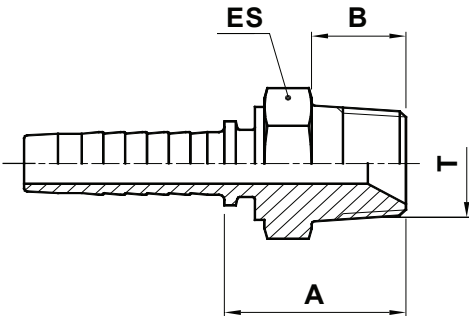

**B**

**TWO PIECE SWAGED FITTINGS UNIVERSAL SERIES FOR WIRE BRAIDED AND 4 SPIRAL HYDRAULIC HOSES**  
**RACCORDI A PRESSARE - SERIE UNIVERSALE PER TUBI TRECCIATI E 4 SPIRALI**  
**PRESSARMATUREN UNIVERSALSERIE FÜR GEFLECHT - UND SPIRALSCHLÄUCHE**  
**RACORES A PRENSAR SERIE UNIVERSAL PARA MANGUERA DE UNA O DOS MALLAS Y 4 ESPIRALES**

**NPTF****MN10B**

MNA10B\*

**10250****NPTF MALE (60° CONE SEAT)****MASCHIO NPTF SV. 60°**

**AGN ANSCHLUSSSTUTZEN MIT KONISCHEM  
 NPTF-GEWINDE SELBSTDICHTEND  
 60° KONUS**

**MACHO FIJO NPTF CONO 60°**

CODE CODICE BEST.-NR CODIGO	Ø HOSE Ø TUBO Ø SCHLAUCH Ø MANGUERA			T	A		B		ES		
	DN	INCH	SIZE		[mm]	[in]	[mm]	[in]	[mm]	[in]	↗[in]
MN10B-02-02	3	1/8"	02	1/8" - 27	20,8	0,82	9,5	0,37	11,11	0,437	7/16"
MN10B-03-02	5	3/16"	03	1/8" - 27	20,8	0,82	9,5	0,37	11,11	0,437	7/16"
MN10B-03-04	5	3/16"	03	1/4" - 18	25,8	1,02	14	0,55	14	0,551	9/16"
MN10B-04-02	6	1/4"	04	1/8" - 27	22,1	0,87	9,6	0,38	14	0,551	9/16"
MN10B-04-04	6	1/4"	04	1/4" - 18	26,5	1,04	14	0,55	14	0,551	9/16"
MN10B-04-06	6	1/4"	04	3/8" - 18	28	1,10	14	0,55	19	0,748	3/4"
MN10B-04-08	6	1/4"	04	1/2" - 14	33	1,30	19	0,75	22	0,866	7/8"
MN10B-05-04	8	5/16"	05	1/4" - 18	26,5	1,04	14	0,55	14	0,551	9/16"
MN10B-05-06	8	5/16"	05	3/8" - 18	28	1,10	14	0,55	19	0,748	3/4"
MN10B-06-04	10	3/8"	06	1/4" - 18	26,5	1,04	14	0,55	17	0,669	11/16"
MN10B-06-06	10	3/8"	06	3/8" - 18	28	1,10	14	0,55	19	0,748	3/4"
MN10B-06-08	10	3/8"	06	1/2" - 14	33	1,30	19	0,75	22	0,866	7/8"
MN10B-08-04	12	1/2"	08	1/4" - 18	28,5	1,12	14	0,55	22	0,866	7/8"
MN10B-08-06	12	1/2"	08	3/8" - 18	28,5	1,12	14	0,55	19	0,748	3/4"
MN10B-08-08	12	1/2"	08	1/2" - 14	33,5	1,32	19	0,75	22	0,866	7/8"
MN10B-08-12	12	1/2"	08	3/4" - 14	34	1,34	19	0,75	27	1,063	1.1/16"
MN10B-10-08	16	5/8"	10	1/2" - 14	33,5	1,32	19	0,75	24	0,945	15/16"
MN10B-10-12	16	5/8"	10	3/4" - 14	41	1,61	19	0,75	27	1,063	1.1/16"
MN10B-12-08	19	3/4"	12	1/2" - 14	34,5	1,36	19	0,75	27	1,063	1.1/16"
MN10B-12-12	19	3/4"	12	3/4" - 14	41,5	1,63	19	0,75	27	1,063	1.1/16"

